



PLUM RIDGE PLACE *at Jerome Village*

Welcome to Plum Ridge Place, a gated neighborhood nestled within Eversole Run that includes 22 custom home sites ranging in size from a half-acre to approximately 1-acre with home prices starting at over \$1.5 million exceeding upwards of \$2 million. This community offers desired privacy encompassed by trees, ponds and a ravine, and supreme access to community amenities.

As part of the Jerome Village family, you will belong to a distinctive community located within Dublin City Schools where residents enjoy abundant lifestyle amenities like a new community center with an outdoor pool, fitness center and restaurant. The community's parks, tree-lined parkways, wetlands, ponds and 15-mile network of trails serve as natural anchors within 600 acres of green space.

Select one of only 22 exclusive lots and then choose to work with an approved custom builder to design your next home, a special place where you and your family can build memories for generations to come.

Inquire today, or better yet – go tour this exclusive neighborhood and see what these beautiful lots have to offer. Plum Ridge Place is a community unmatched in natural beauty, privacy and the features you desire for the ultimate in high-quality living.

JEROME VILLAGE

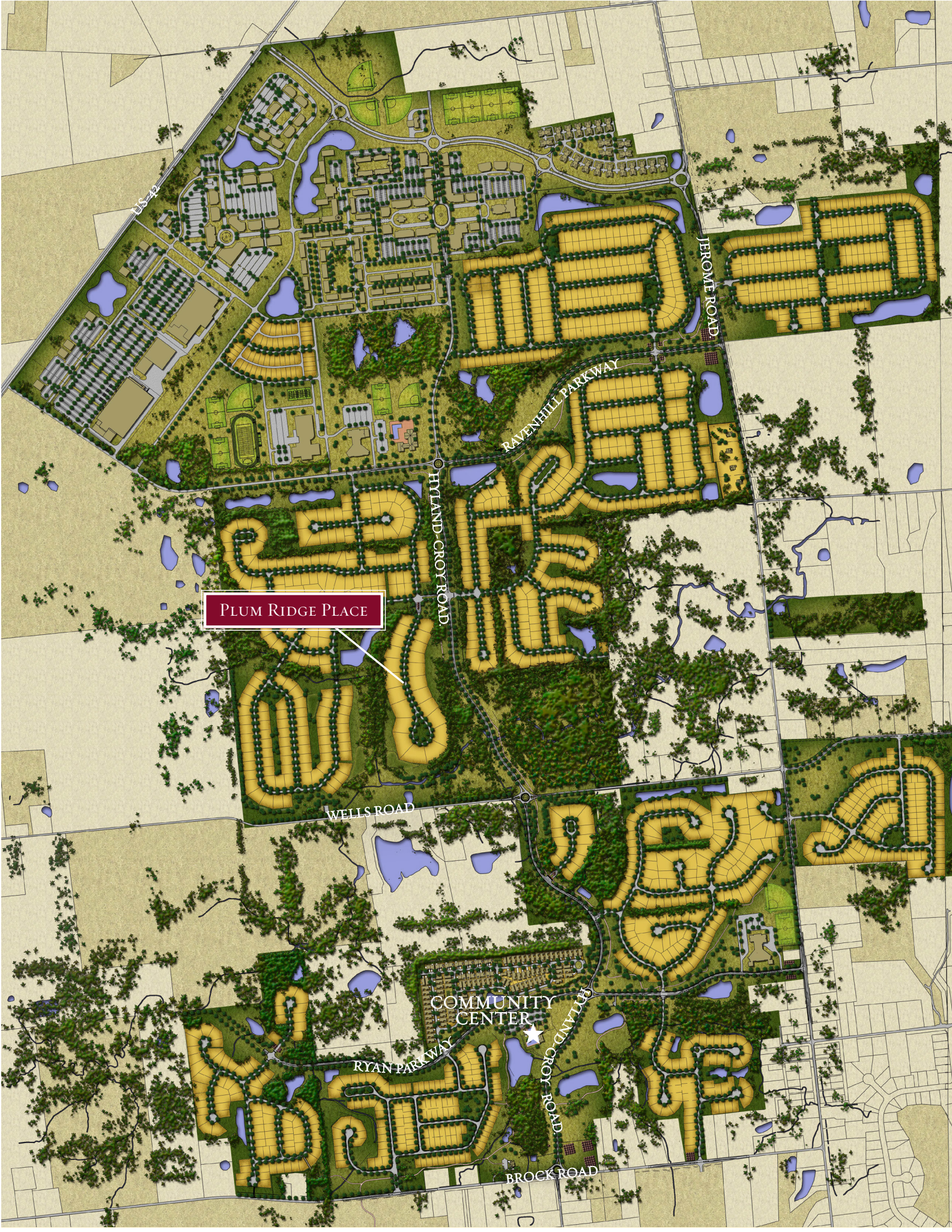

PLUM RIDGE PLACE

COMMUNITY CENTER

US 42

JEROME ROAD

RAVENHILL PARKWAY

HYLAND CROFT ROAD

WELLS ROAD

COMMUNITY CENTER

RYAN PARKWAY

HYLAND CROFT ROAD

BROCK ROAD



FIND A SPACE *that's right for you.*

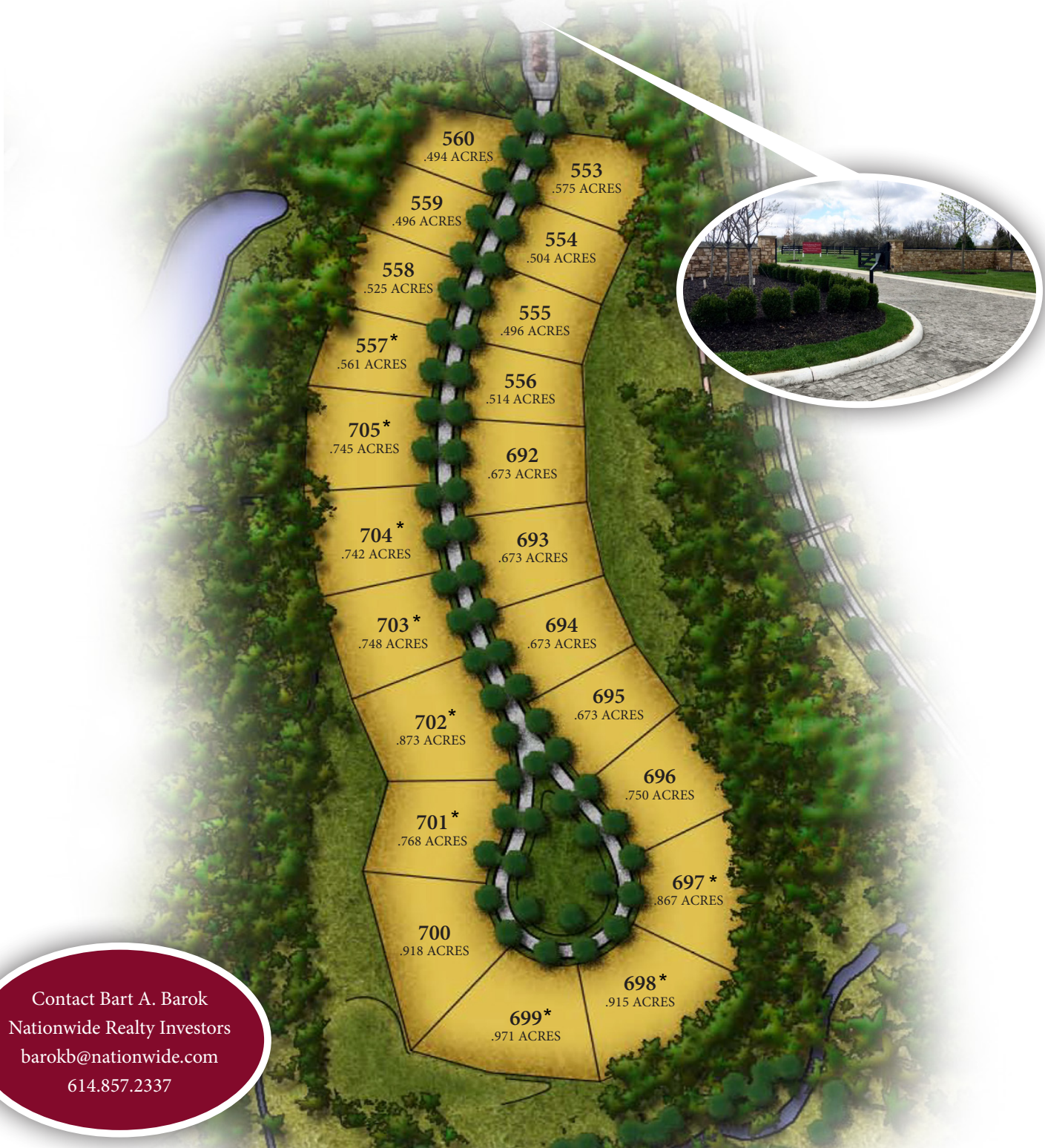

Contact Bart A. Barok
Nationwide Realty Investors
barokb@nationwide.com
614.857.2337

PLUM RIDGE PLACE

at Jerome Village

| LOT NO. | ACRES | PRICE |
|---------|-------|-------------------------|
| 553 | 0.575 | \$255,200 |
| 554 | 0.504 | \$234,900 |
| 555 | 0.496 | SOLD |
| 556 | 0.514 | SOLD |
| 557* | 0.561 | \$252,000 |
| 558 | 0.525 | CONTRACT PENDING |
| 559 | 0.496 | \$230,900 |
| 560 | 0.494 | IN CONTRACT |
| 692 | 0.673 | SOLD |
| 693 | 0.673 | \$298,600 |
| 694 | 0.673 | SOLD |
| 695 | 0.673 | \$298,600 |
| 696 | 0.750 | SOLD |
| 697* | 0.867 | SOLD |
| 698* | 0.915 | SOLD |
| 699* | 0.971 | \$359,200 |
| 700 | 0.918 | SOLD |
| 701* | 0.768 | SOLD |
| 702* | 0.873 | \$398,900 |
| 703* | 0.748 | \$325,600 |
| 704* | 0.742 | \$324,600 |
| 705* | 0.745 | \$325,100 |

* Walkout Lot

