

ASH GROVE NEIGHBORHOOD *at Jerome Village*

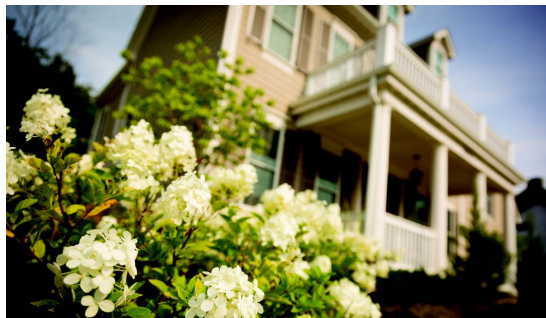

Welcome to Ash Grove Neighborhood, an exclusive neighborhood at Jerome Village , that includes 15 custom home sites nestled within a wooded cul-de-sac. Home prices are expected to range from \$550,000 - \$750,000. This community is surrounded by trees, ponds and a ravine, and offers supreme access to community amenities.

As part of the Jerome Village family, you will belong to a distinctive community located within Dublin City Schools where residents enjoy abundant lifestyle amenities like the community center which includes an outdoor pool, fitness center and restaurant. The community's park system includes 600 acres of green space, connection to the Glacier Ridge Metro park, wetlands, ponds and 15 miles of trails.

Contact Samantha Grieser at grieses1@nationwide.com for more information. Lots will be available for purchase Summer of 2020.

➤ FIND A SPACE *that's right for you.*

ASH GROVE NEIGHBORHOOD

at Jerome Village

LOT NO.	ACRES	PRICE
1	0.29	\$137,900
2	0.28	\$145,200
3	0.28	\$139,000
4	0.31	IN CONTRACT
5	0.27	\$141,400
6	0.27	\$141,100
7	0.27	IN CONTRACT
8	0.28	\$142,300
9	0.37	IN CONTRACT
10	0.37	IN CONTRACT
11 *	0.38	IN CONTRACT
12 *	0.27	IN CONTRACT
13 *	0.27	IN CONTRACT
14 *	0.27	IN CONTRACT
15 *	0.27	\$148,100

* Walkout Lot

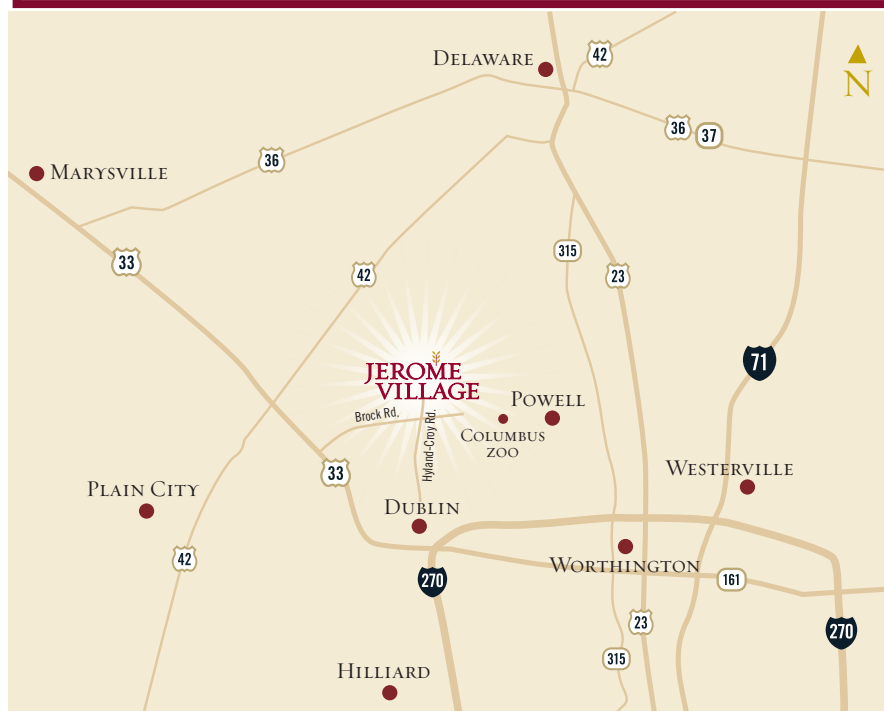
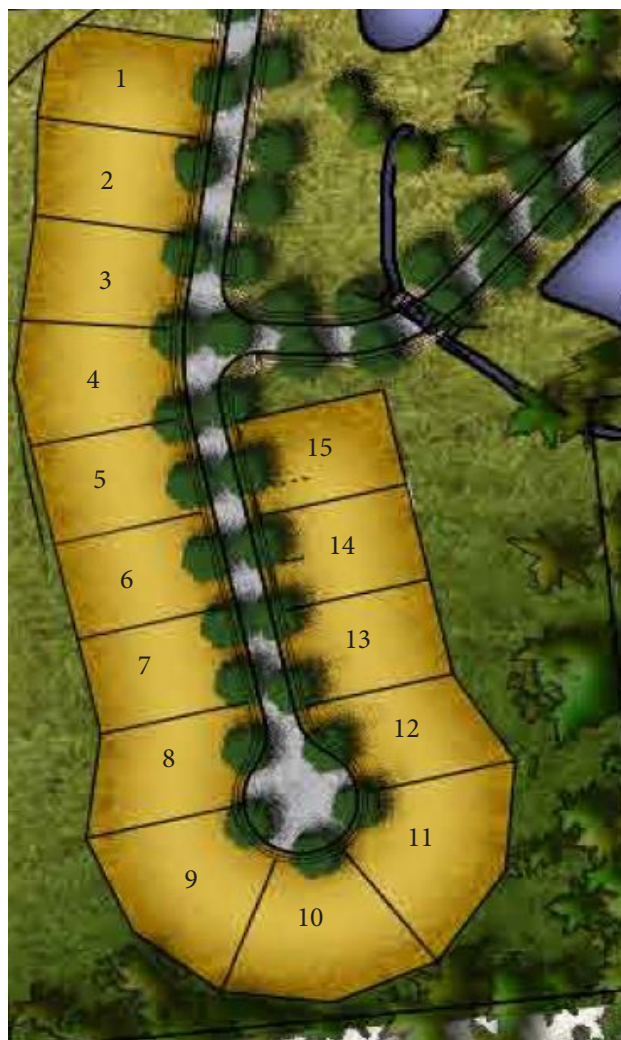

**JEROME
VILLAGE**

JEROMEVILLAGE.COM 



DEVELOPED BY
NATIONWIDE REALTY INVESTORS