



Discover a truly
EXQUISITE NEIGHBORHOOD
TO CALL HOME.



PLUM RIDGE PLACE *at Jerome Village*

Welcome to Plum Ridge Place, a gated neighborhood nestled within Eversole Run that includes 22 custom home sites ranging in size from a half-acre to approximately 1-acre with home prices starting at over \$1.5 million exceeding upwards of \$2 million. This community offers desired privacy encompassed by trees, ponds and a ravine, and supreme access to community amenities.

As part of the Jerome Village family, you will belong to a distinctive community located within Dublin City Schools where residents enjoy abundant lifestyle amenities like a new community center with an outdoor pool, fitness center and restaurant. The community's parks, tree-lined parkways, wetlands, ponds and 15-mile network of trails serve as natural anchors within 600 acres of green space.

Select one of only 22 exclusive lots and then choose to work with an approved custom builder to design your next home, a special place where you and your family can build memories for generations to come.

Inquire today, or better yet – go tour this exclusive neighborhood and see what these beautiful lots have to offer. Plum Ridge Place is a community unmatched in natural beauty, privacy and the features you desire for the ultimate in high-quality living.

JEROME VILLAGE

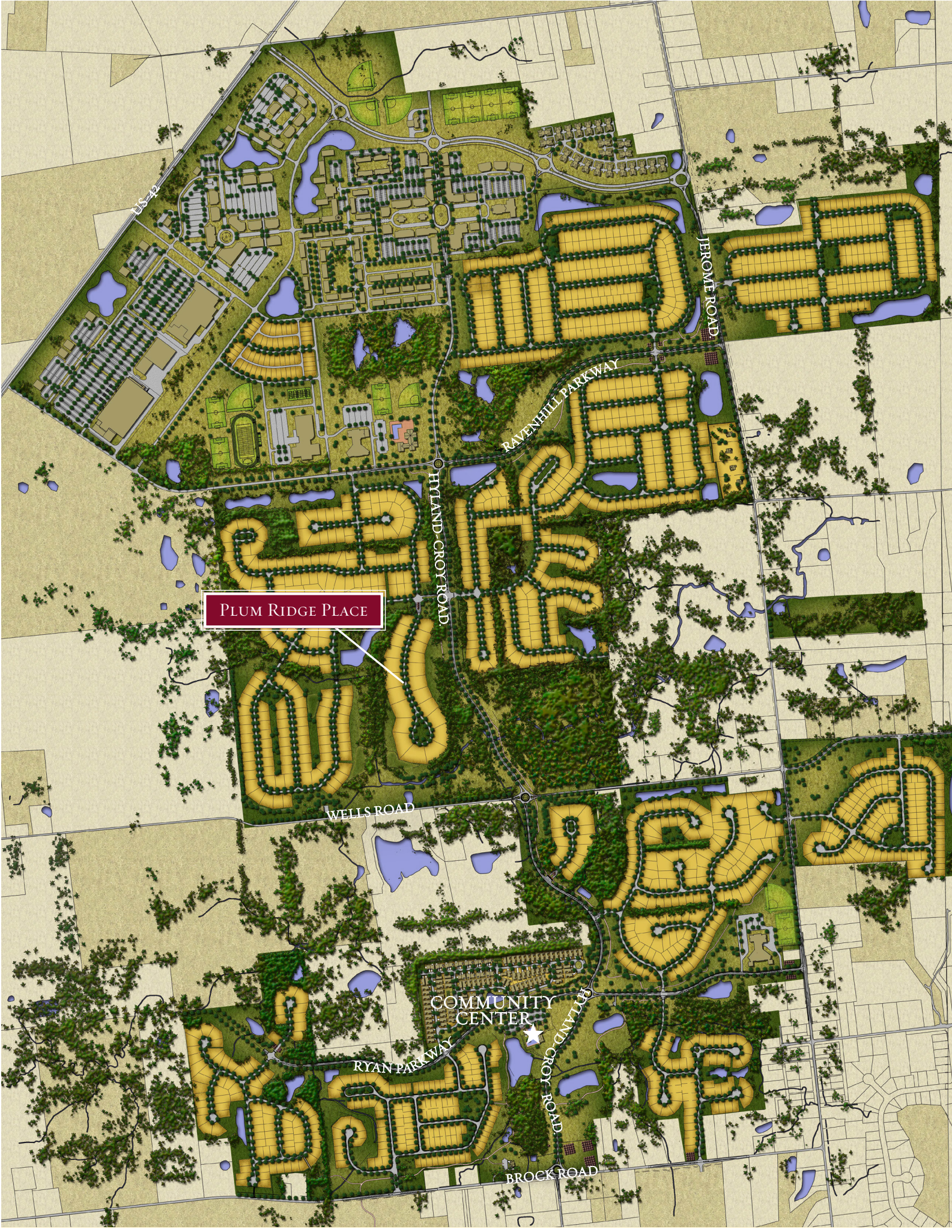

PLUM RIDGE PLACE

COMMUNITY CENTER

US 42

JEROME ROAD

RAVENHILL PARKWAY

HIGHLAND CROFT ROAD

WELLS ROAD

COMMUNITY CENTER

RYAN PARKWAY

HIGHLAND CROFT ROAD

BROCK ROAD



FIND A SPACE *that's right for you.*

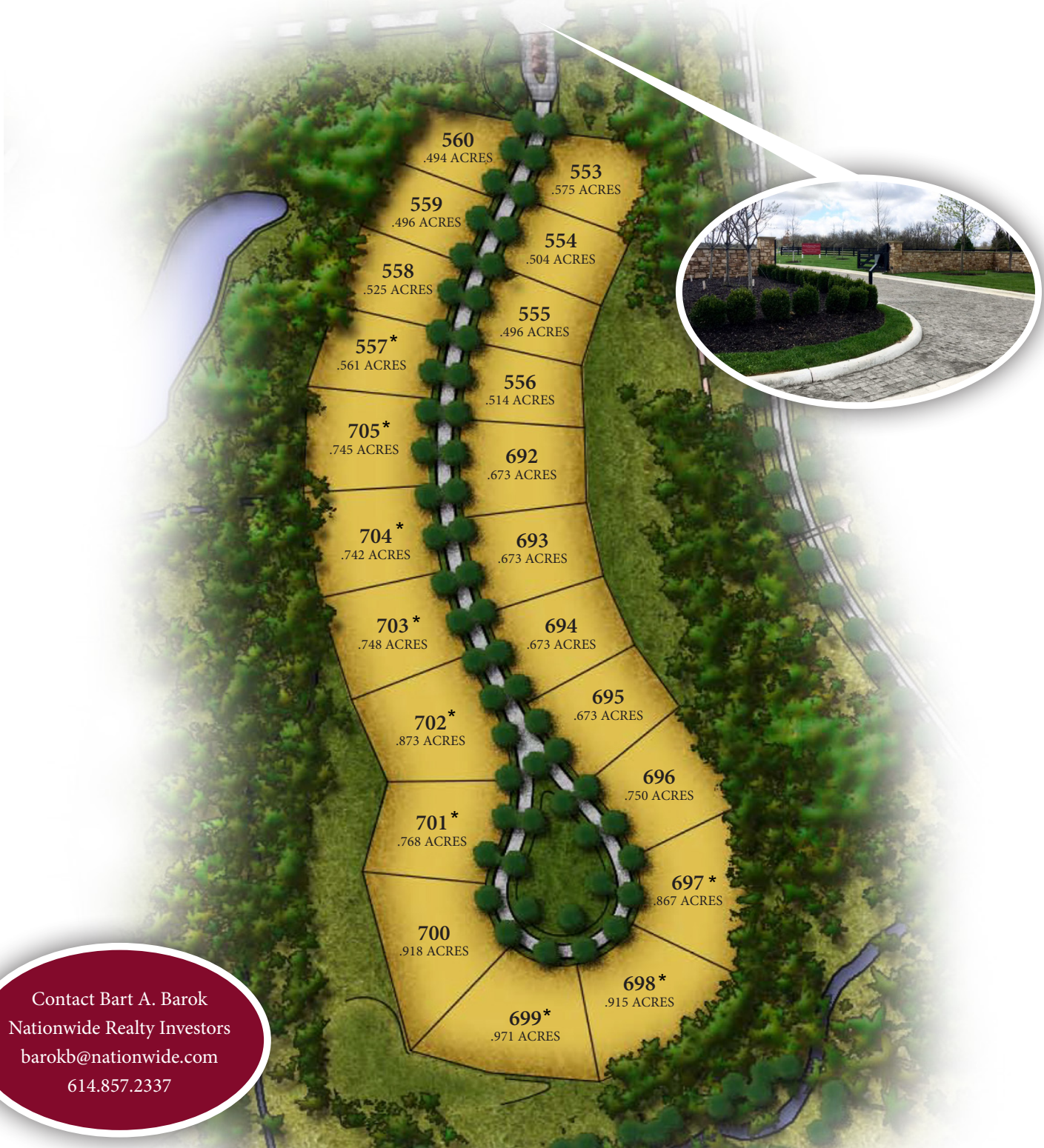

Contact Bart A. Barok
 Nationwide Realty Investors
 barokb@nationwide.com
 614.857.2337

PLUM RIDGE PLACE

at Jerome Village

LOT NO.	ACRES	PRICE
553	0.575	IN CONTRACT
554	0.504	SOLD
555	0.496	SOLD
556	0.514	SOLD
557*	0.561	SOLD
558	0.525	SOLD
559	0.496	SOLD
560	0.494	SOLD
692	0.673	SOLD
693	0.673	IN CONTRACT
694	0.673	SOLD
695	0.673	SOLD
696	0.750	SOLD
697*	0.867	SOLD
698*	0.915	SOLD
699*	0.971	IN CONTRACT
700	0.918	SOLD
701*	0.768	SOLD
702*	0.873	IN CONTRACT
703*	0.748	IN CONTRACT
704*	0.742	CONTRACT PENDING
705*	0.745	IN CONTRACT

* Walkout Lot

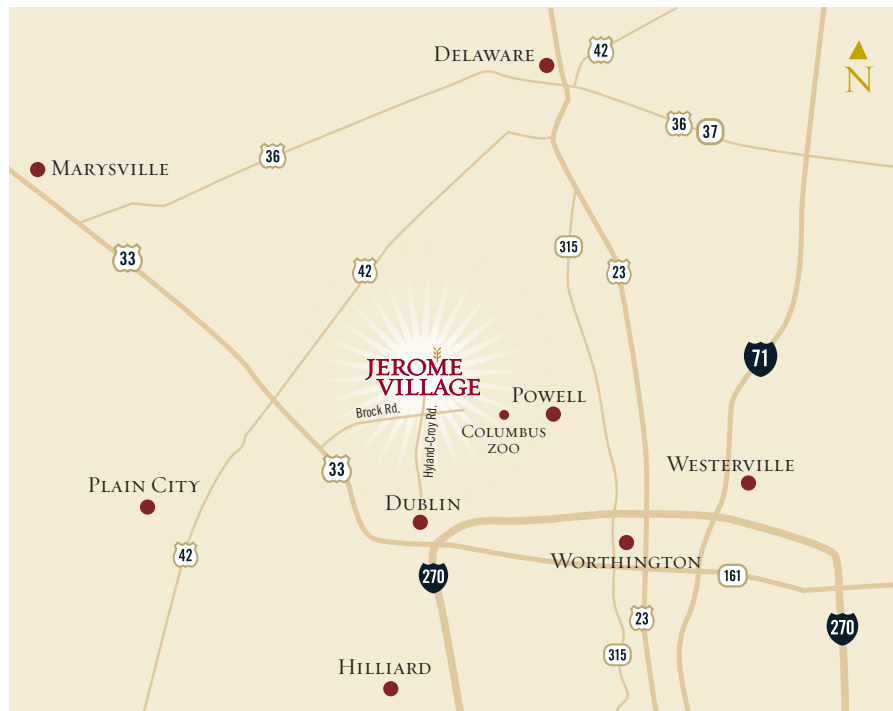

JEROME VILLAGE

JEROMEVILLAGE.COM 

 **Nationwide**

DEVELOPED BY
NATIONWIDE REALTY INVESTORS